

CITY OF BATAVIA

CONTROL MONUMENT DIAGRAM

STATION NAME: BATAVIA 104 DATE SET: 6-26-2006 OBSERVATION: 10-31-2017

MONUMENT TYPE: STAINLESS STEEL ROD IN SLEEVE

HORIZONTAL DATUM: NAD 83 (2011), IL EAST ZONE		US FEET	METERS	ACCURACY
LATITUDE: 41°49'21.40755"	NORTHING:	1877953.36	572401.330	NETWORK 0.55 CM
LONGITUDE: 88°17'28.46273"	EASTING:	995723.32	303497.076	

COMBINED SCALE FACTOR: 0.99994262

ORTHOMETRIC HEIGHT	FEET	METERS	DATUM	ACCURACY		
	789.22	240.555	NAVD88	2ND ORDER CLASS I		
ELLIPSOIDAL HEIGHT	FEET	METERS	GEOID HEIGHT	FEET	METERS	SOURCE
	680.56	207.435		-108.59	-33.097	GEOID 12B

STATION DESCRIPTION: STEEL ROD WITH DATUM POINT AND 6 INCH LID, 202 FT SE OF SIDEWALK, 117 FT SW OF FENCE CORNER, 121 FT NW OF FENCE CORNER, 67 FT NW OF N EDGE PATH, 28 FT NE OF E CURB OF PLAYGROUND

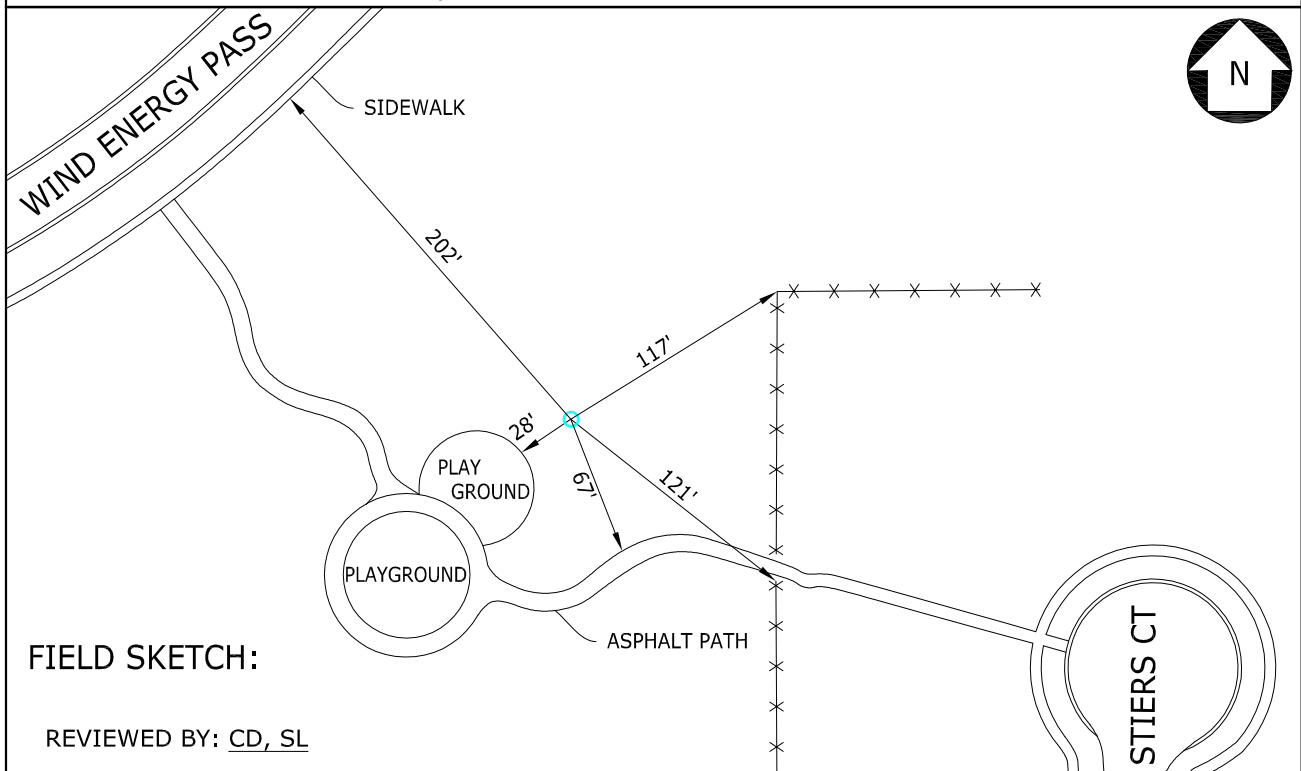

S:\CITY_OF_BATAVIA\21707.088 BENCHMARK UPGRADE\15_SURVEY\15.4_DRAWING_DATA\BATAVIA 104 SET 6-26-2006.DWG

