

CITY OF BATAVIA

CONTROL MONUMENT DIAGRAM

STATION NAME: BATAVIA 101 DATE SET: 4-4-2005 OBSERVATION: 11-3-2017

MONUMENT TYPE: ALUMINUM ROD IN SLEEVE

HORIZONTAL DATUM: NAD 83 (2011), IL EAST ZONE		US FEET	METERS	ACCURACY
LATITUDE: 41°51'10.90302"	NORTHING:	1889034.66	575778.917	NETWORK 0.31 CM
LONGITUDE: 88°18'32.72600"	EASTING:	990854.64	302013.097	

COMBINED SCALE FACTOR: 0.99994819

ORTHOMETRIC HEIGHT	FEET	METERS	DATUM	ACCURACY
	670.53	204.377	NAVD88	2ND ORDER CLASS I

ELLIPSOIDAL HEIGHT	FEET	METERS	GEOID HEIGHT	FEET	METERS	SOURCE
	561.84	171.249		108.65	-33.117	GEOID 12B

STATION DESCRIPTION: ALUMINUM ROD WITH 6 INCH LID, 37.30 FEET WEST OF NORTHWEST BOLT OF LIGHT BASE, 9.65 FEET EAST OF EAST FACE OF BRICK WALK, AND 4.44 FEET NORTH OF CUT CROSS IN CONCRETE CURB.

FIELD SKETCH:

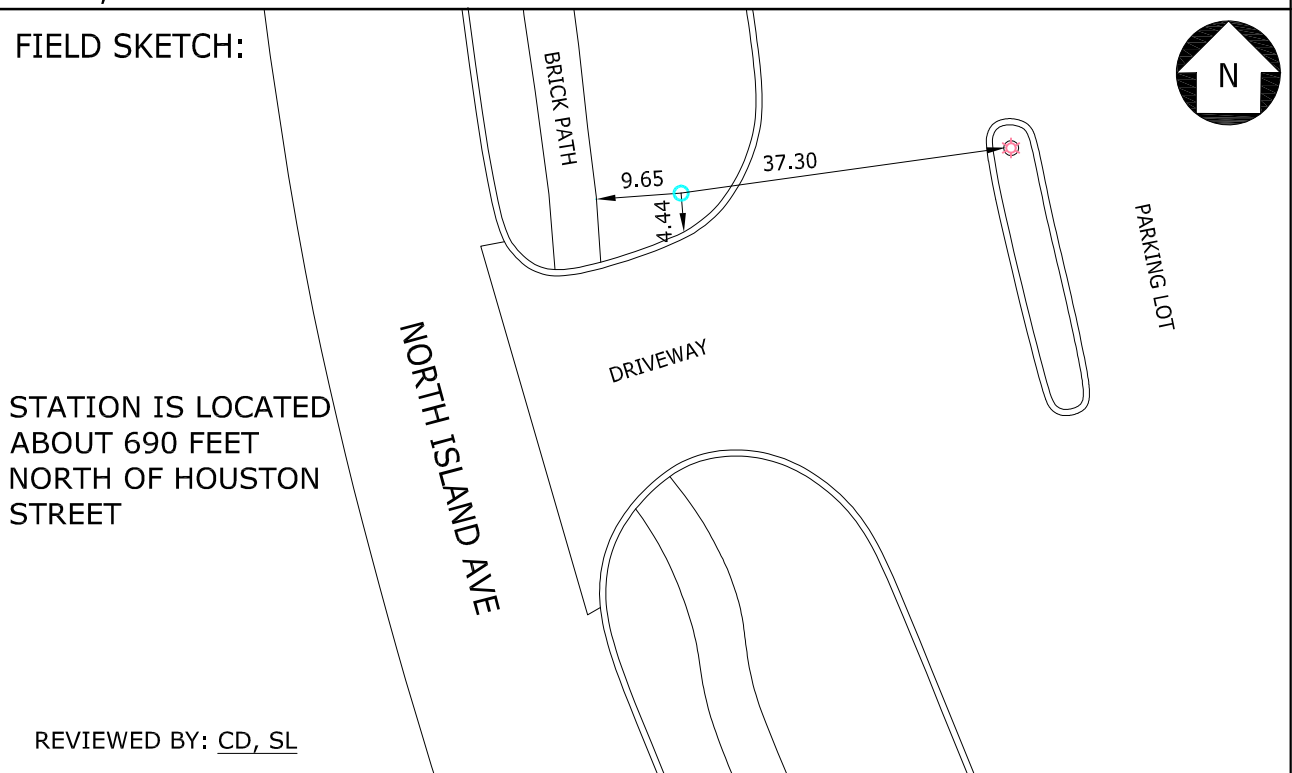

S:\CITY_OF_BATAVIA\21707.088 BENCHMARK UPGRADE\15_SURVEY\15.4_DRAWING_DATA\BATAVIA 101 SET 4-4-2005.DWG

